

**5900**

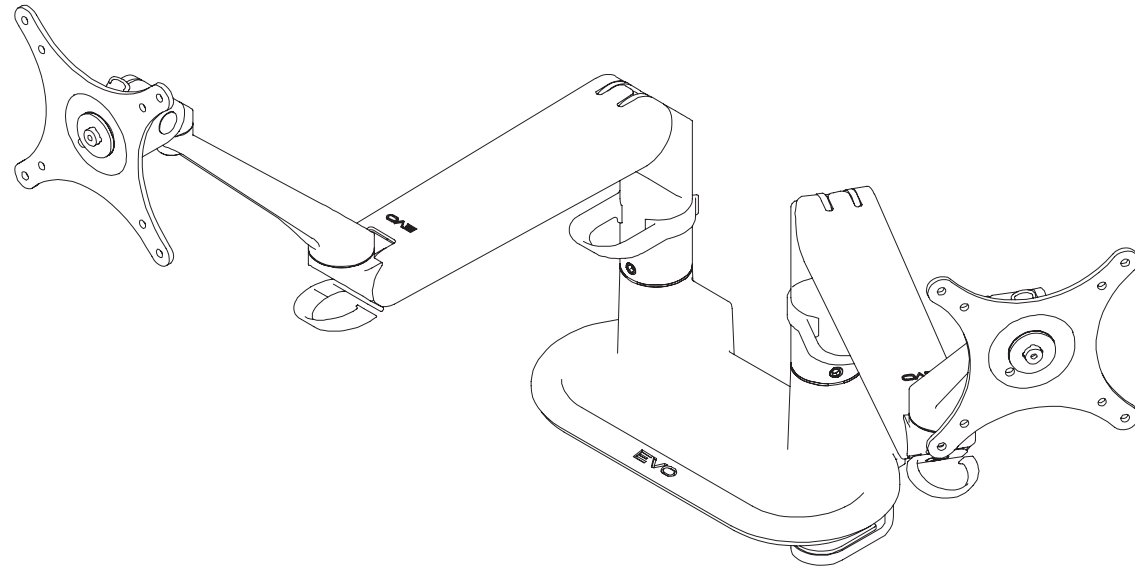

**5902**

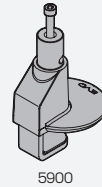
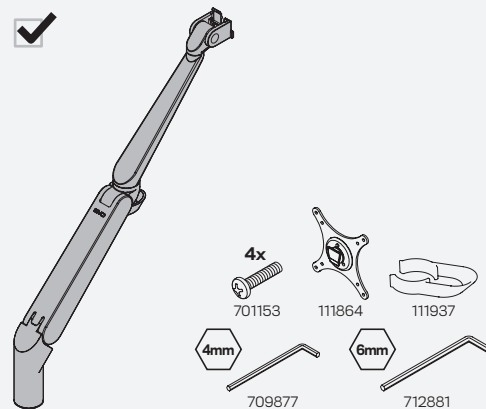
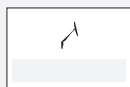

**5900**

or



**8508**



**709667**



**109955**



**110265**



**109886**



**709543**

or

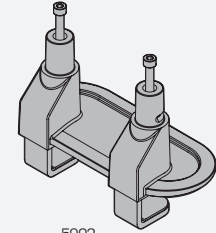

**5902**

**1** **5900 | EVO Single Monitor Mount**

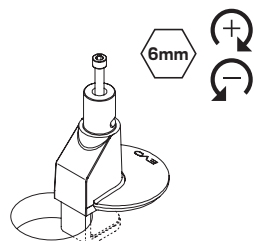
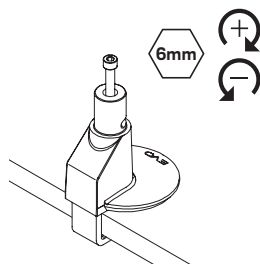

**8508 | Thru-Desk Kit**

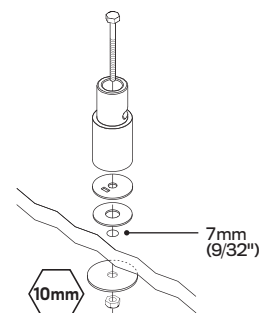
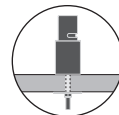

**5902 | EVO Dual Monitor Mount**

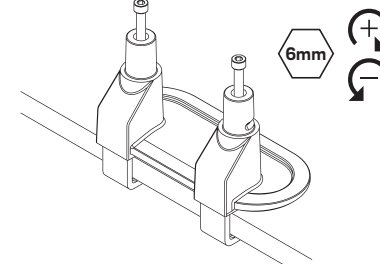

**2**

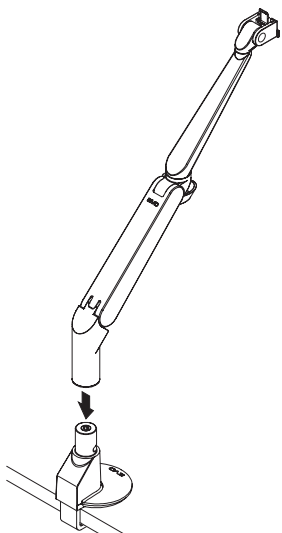

**3**

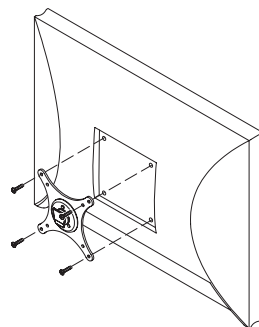

**4**

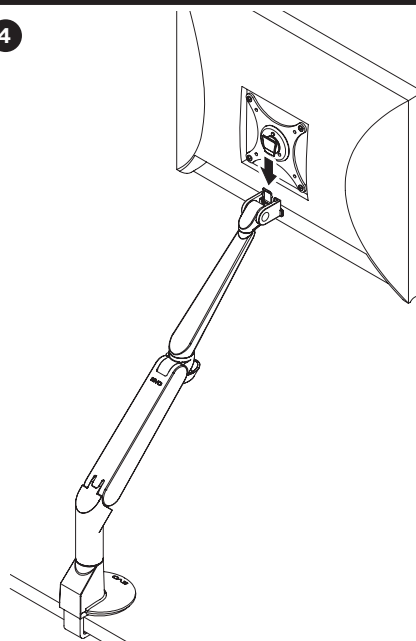

**5**

Hold the arm in the position as shown when adjusting the counterbalance, this will ensure the arm is balanced throughout its range of motion.

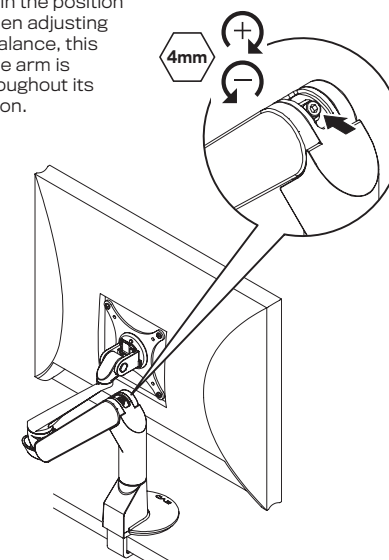

If the arm is balanced, but has a slight drop at the top or a slight lift at the bottom, snug the set screw underneath the arm.

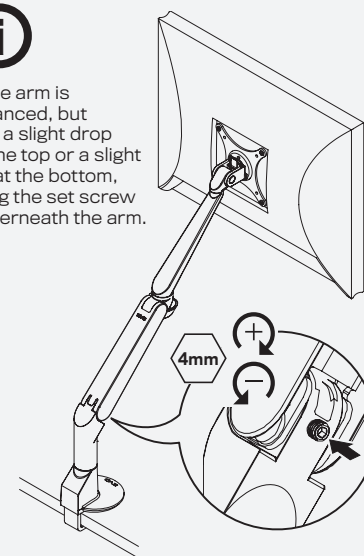

**6**

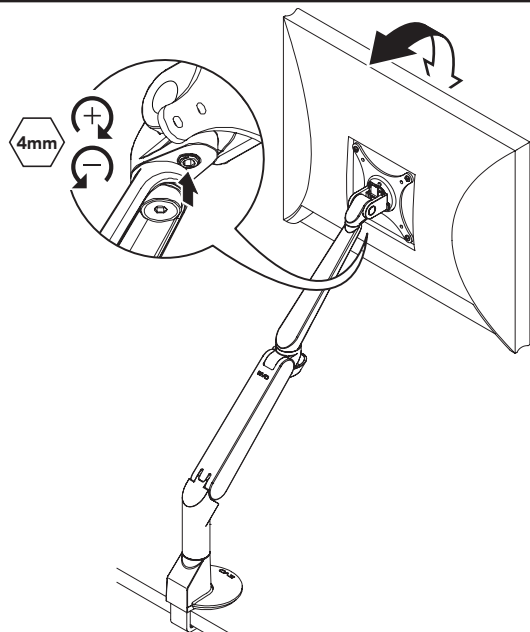

**7**

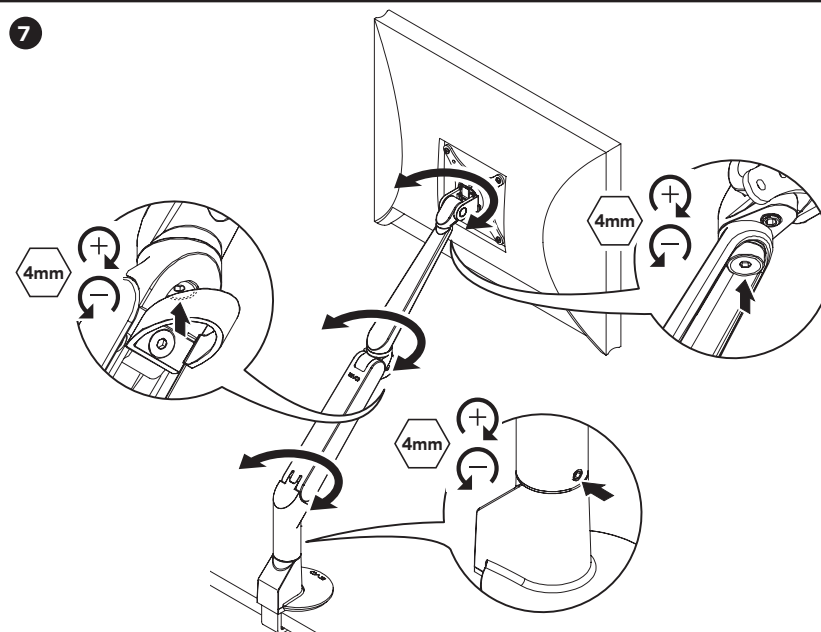

**8**

