

M-SERIES NESTING DESK

Installation Instructions

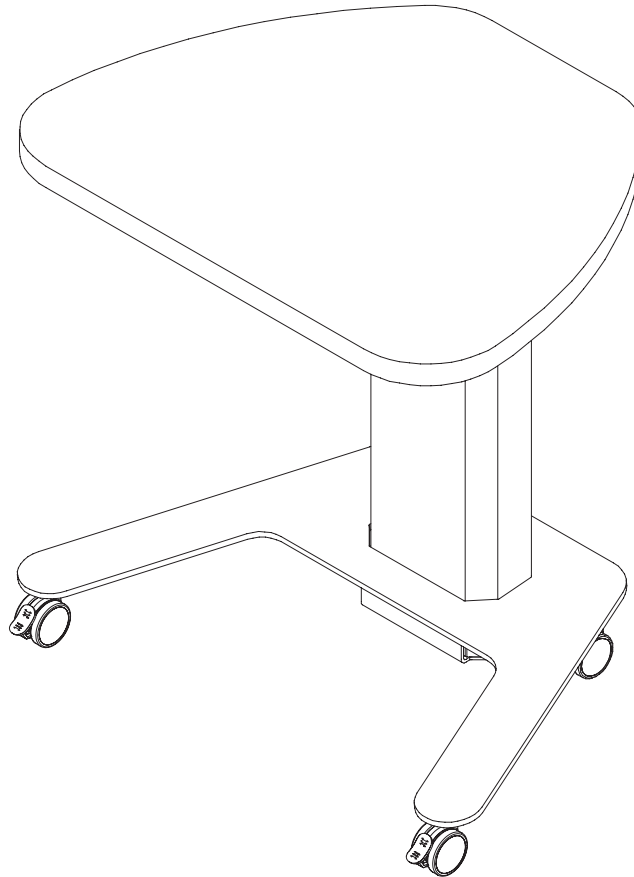

PARTS LIST

Any additional hardware received than what's shown below can be discarded.

A Caster Stem 4x

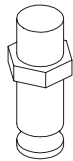

B Locking Casters 2x

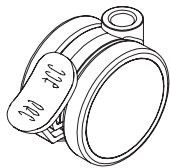

C Non-Locking Casters 2x

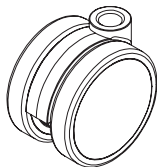

D M6 x 25mm 8x



E Wire Clips 3x



F M4 x 16 Wood Screws 7x



G M8 x 30mm 4x

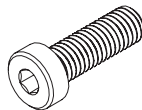

H 4mm Hex Key 1x

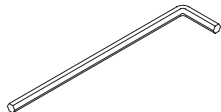

I 5mm Hex Key 1x

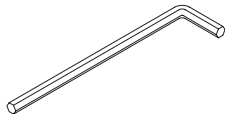

1

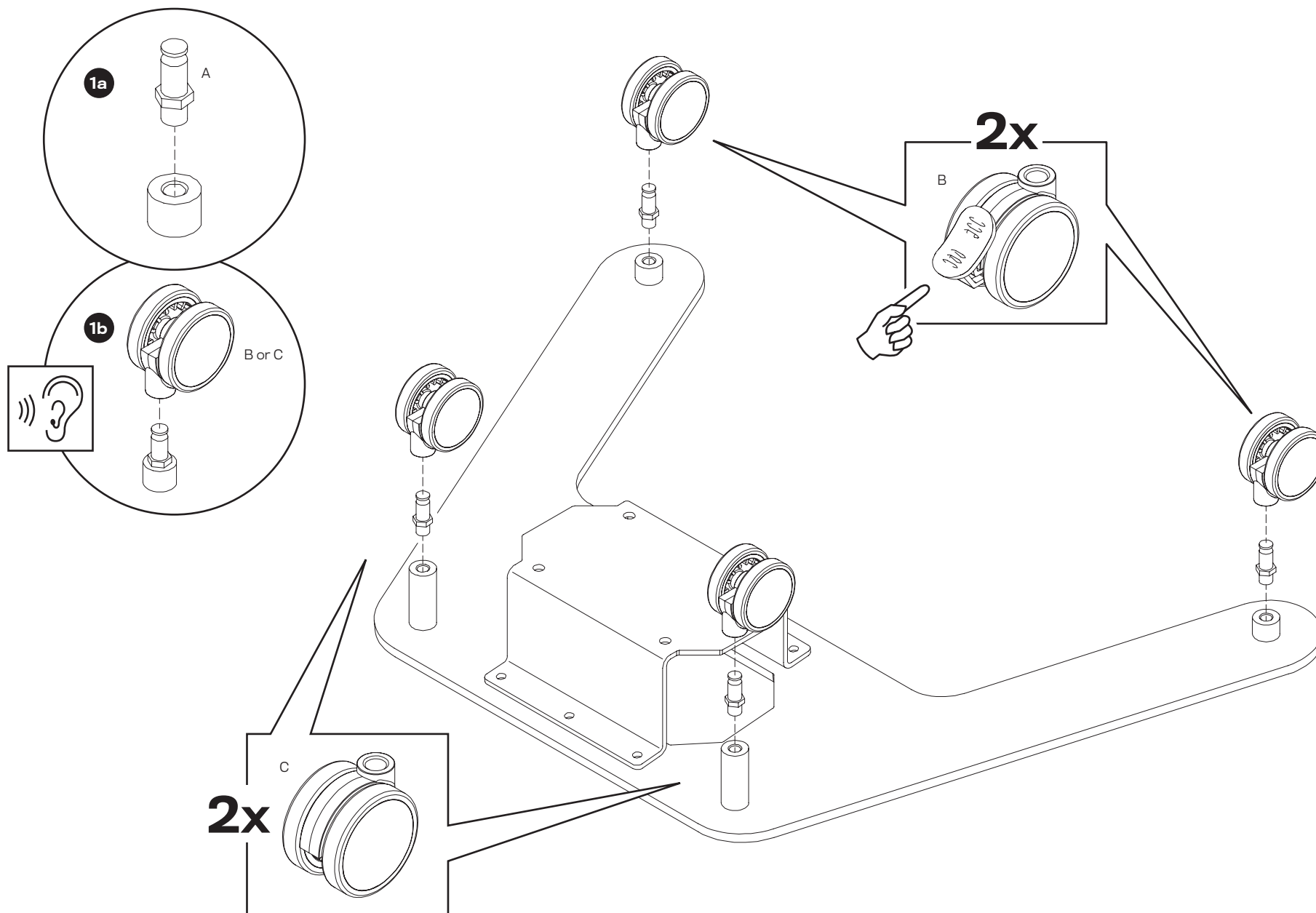

2

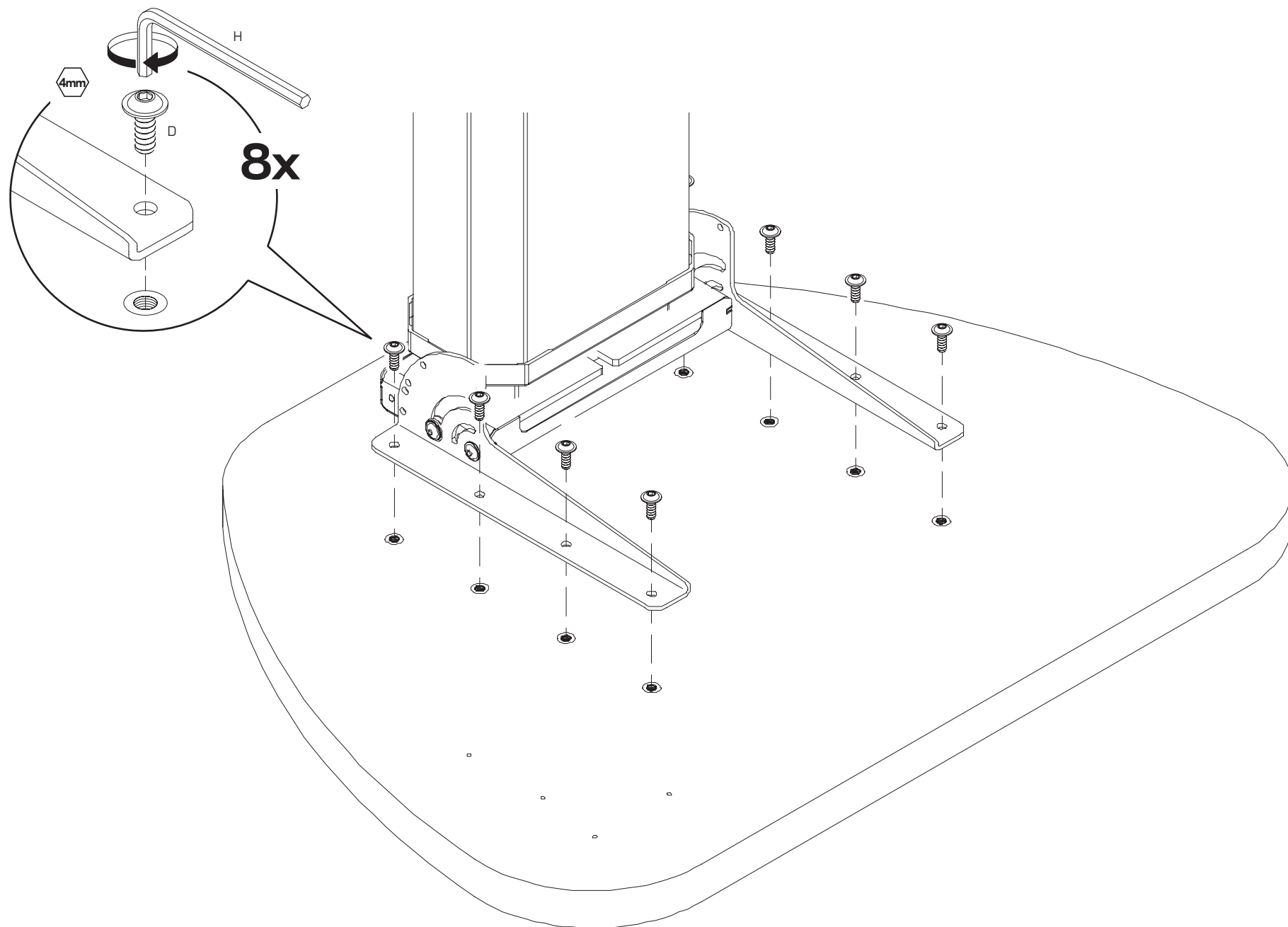

4x

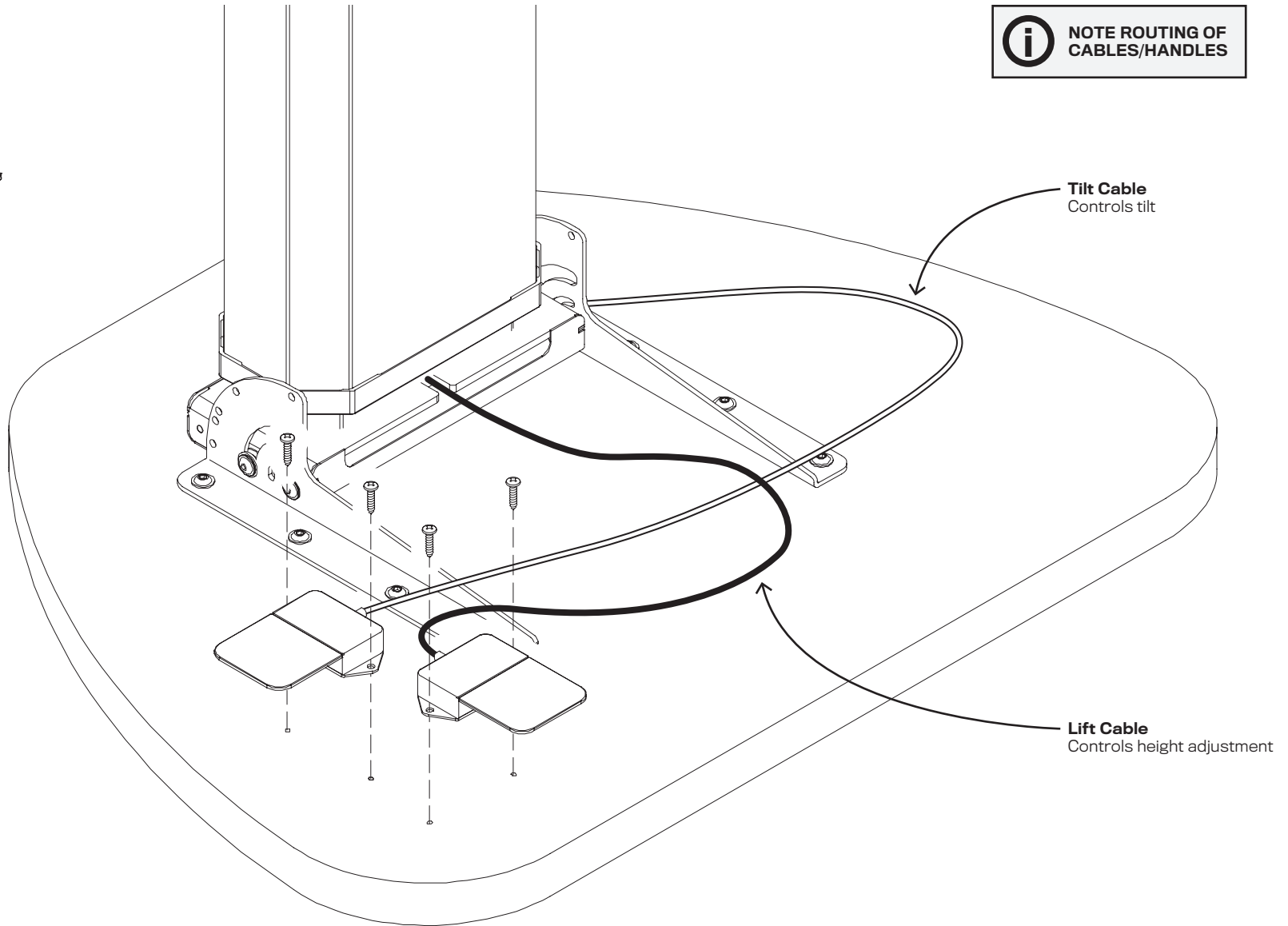

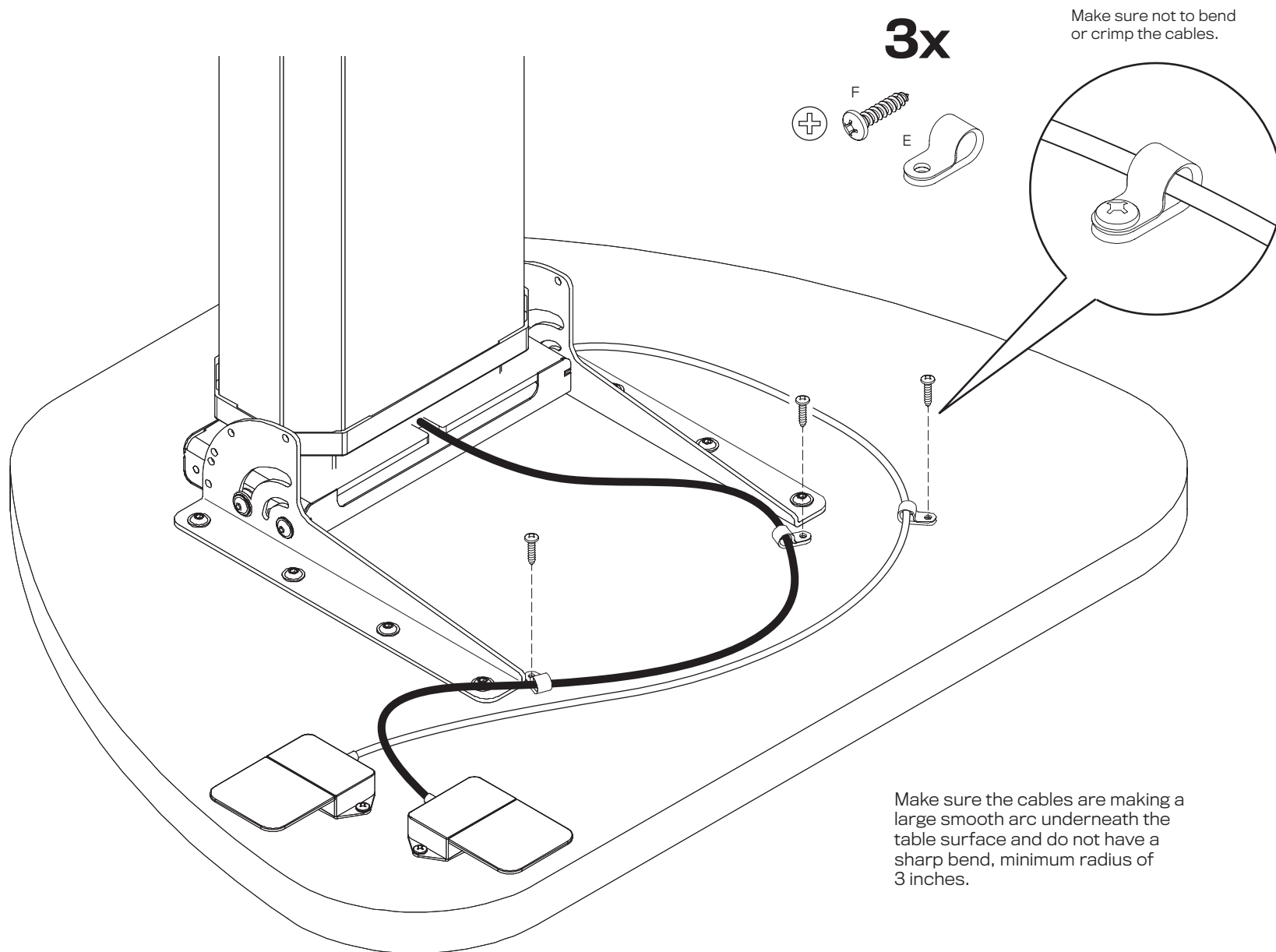

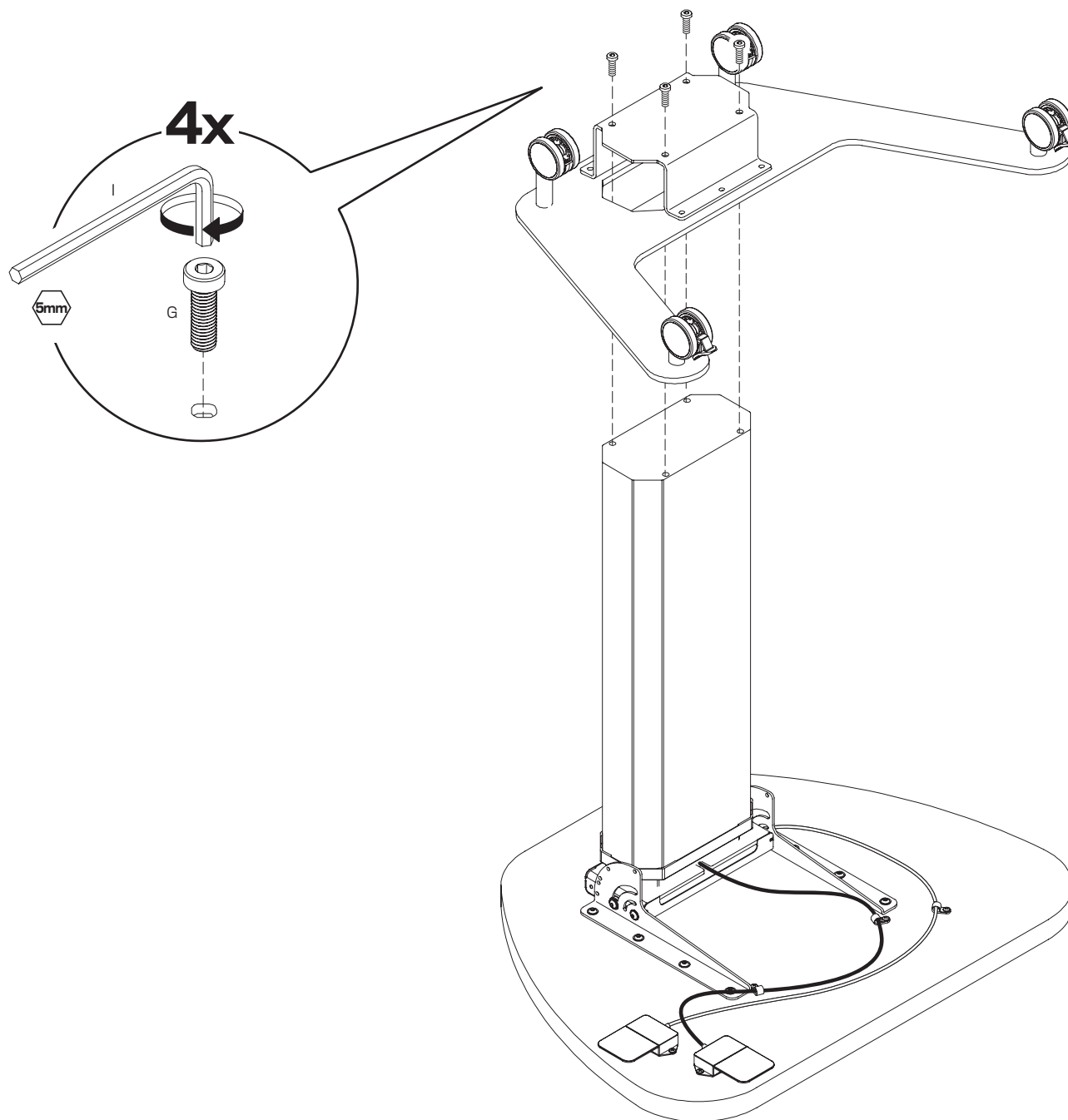

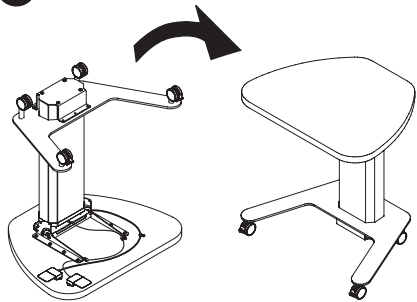
6

Place the assembled table on the floor in upright position. Remove the safety pin by depressing the lift handle, applying downward pressure to the table top, and pulling the pin outward.

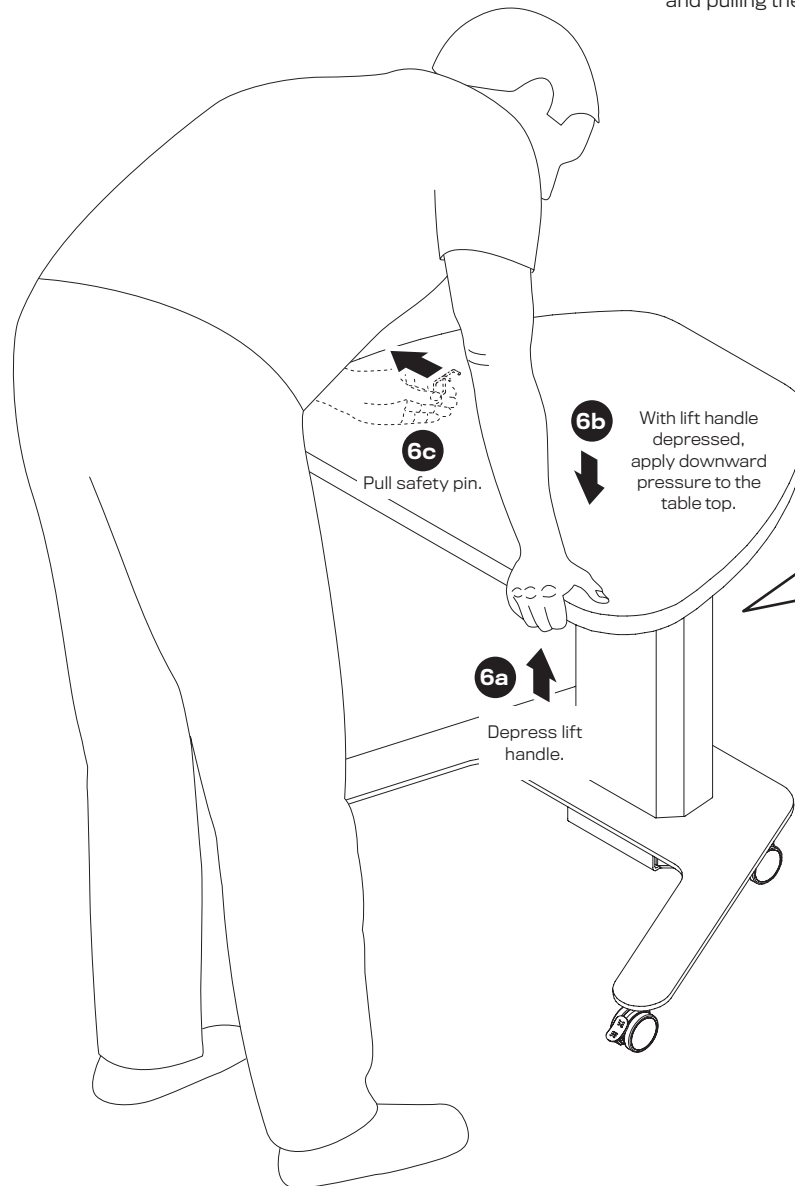

6c
Pull safety pin.

6b
With lift handle depressed,
apply downward pressure to the
table top.

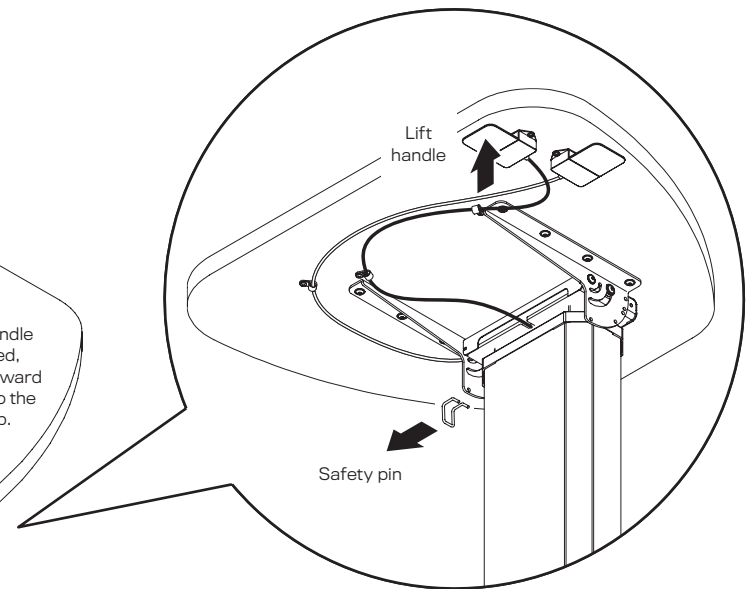

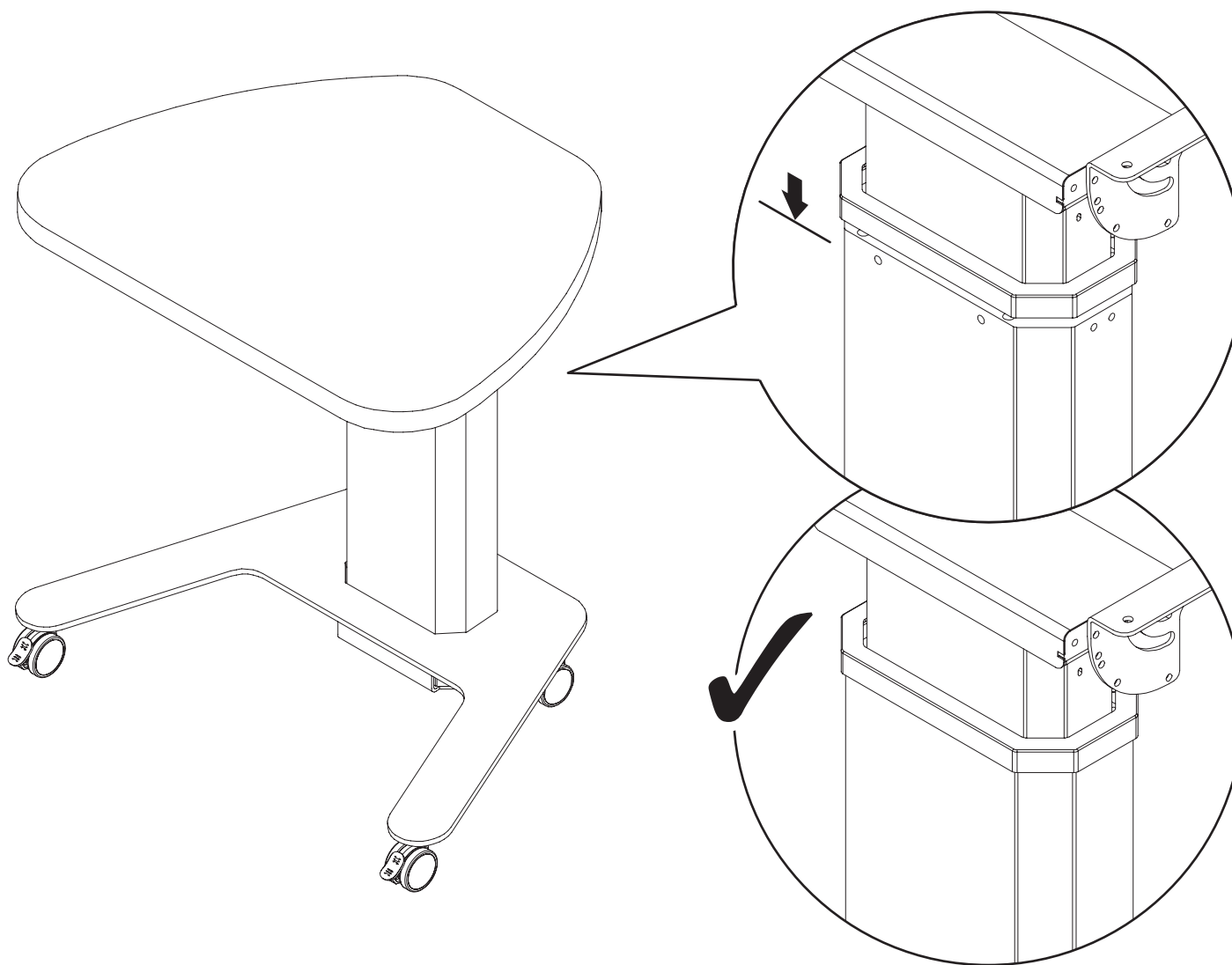

Gently press the column collar
in place on outer column.

Workstation is ready for use.