

M-SERIES QUAD

Installation Instructions

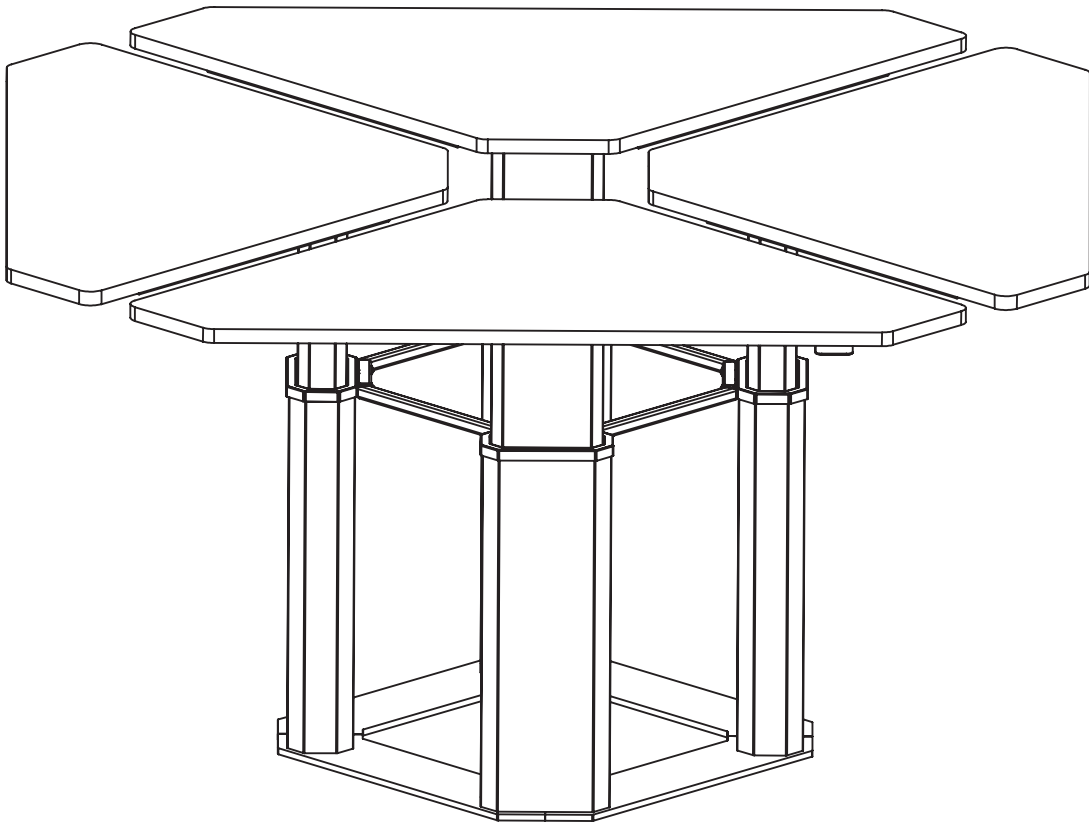

Table of Contents

Safety, preparation and warranty.....	1
Components.....	2
Hardware Bag.....	3
Assembly guide.....	4-10

Safety Instructions

Warning! Failure to comply with or observe all assembly safety and operating instructions and warnings may result in serious bodily injury.

To ensure safe operation:

- Read and understand this manual before attempting to assemble the product.
- Verify that everyone who uses the product is informed of the content of this manual. This is the responsibility of the purchaser.
- Leave this manual near the product or if possible permanently affixed to the desk.

Assembly Preparation

- It is recommended to assemble your desk on a non-abrasive surface to avoid damaging the components.
- Ensure all parts and components listed on page 2+3 have been included.

Components

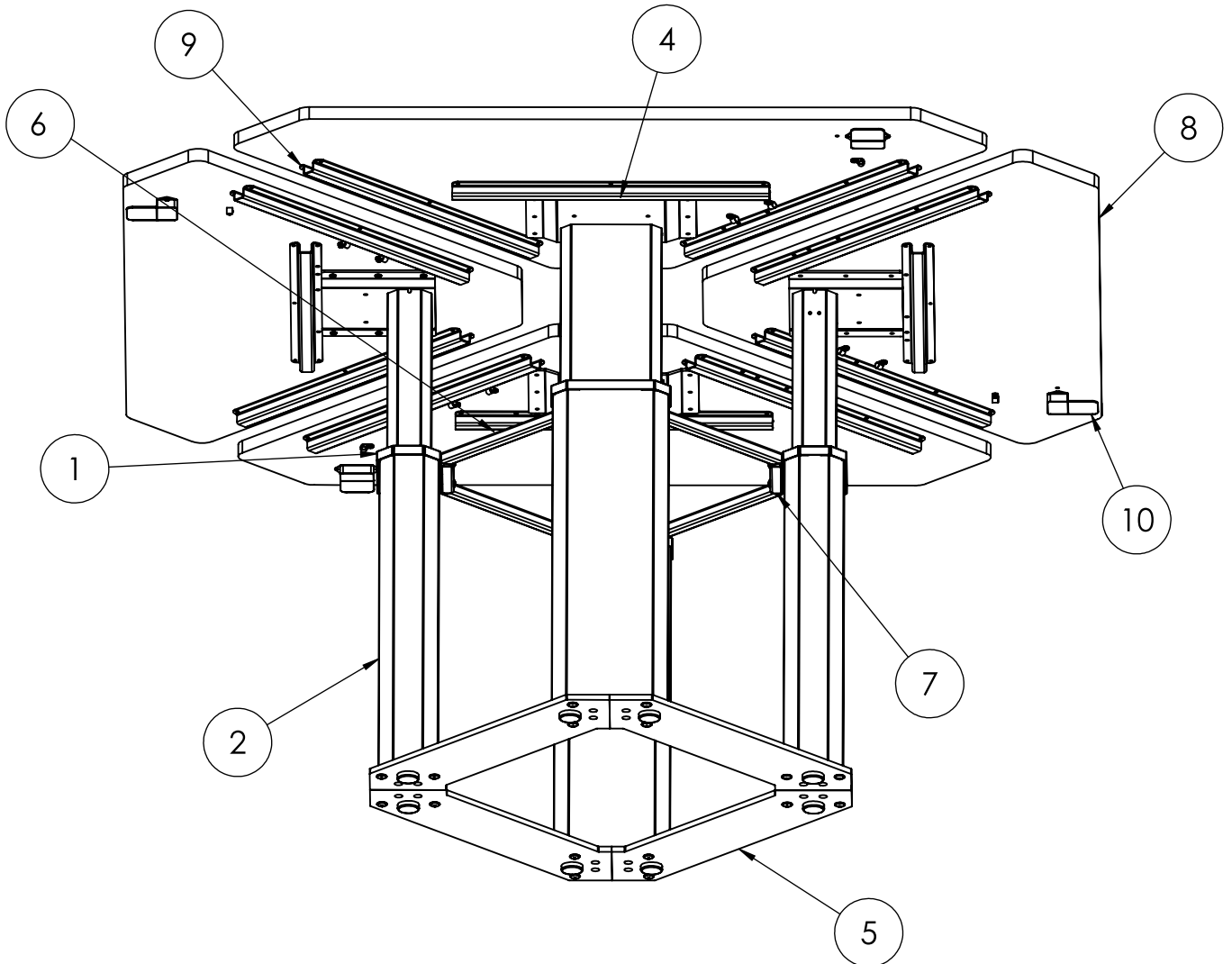

ITEM NO.	Part Name	QTY.
1	Plastic-cover	4
2	Column	4
3	Safety bracket	4
4	Tabletop bracket	4
5	Base	4
6	Framebar	4
7	Framebar bracket	4
8	Adjustable Glide M10x12 Ø38mm	8
9	Hatprofile 25"	12
10	Handle	4
11	Hardware bag	1

Hardware bag



A. 16 x M6x25
RN-084

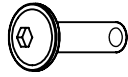

B. 16 x M8x30
RN-083

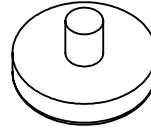

C. 8 x M10x38
RM-175

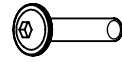

D. 8 x M6x30
R011532



E. 24 x M6x16
RN-081



F. 108 x M5x20
R011530



G. 20 x M4x16PH
R011500



H. 12 x Ø7,9 clamp
R010230



I. 1 x 5mm Hex key
R011905

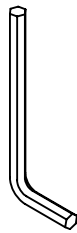

J. 1 x 4mm Hex key
R011921

Tools required: Drill driver, Phillips bit PH2

Step 1. Place plastic-cover

Place a plastic-cover(1) on each column(2), and let it hang freely over the safety bracket(3)

The two cut-outs should face the side of the column with 2 holes

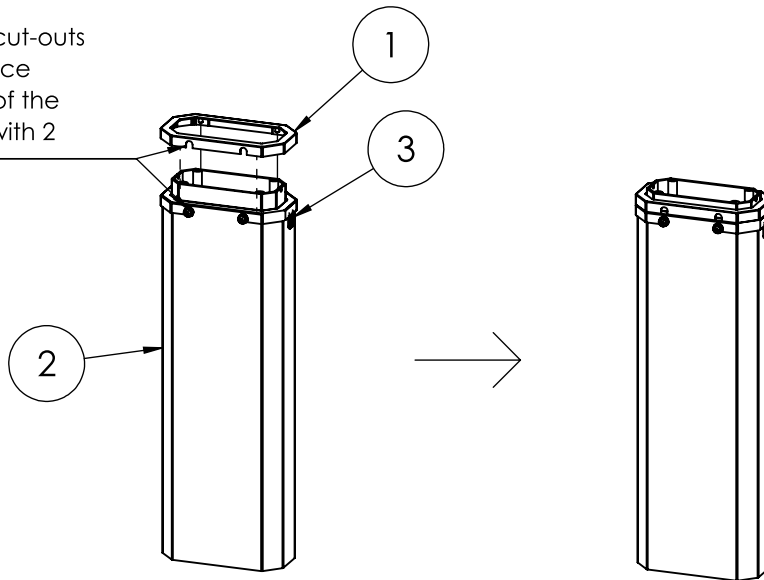

Warning!! Do not remove the safety bracket before the table is fully assembled

Step 2. Mount reinforced top bracket

Place a top bracket(4) on top of each column(2) and mount with four M6x25 machine screws(A). Tighten the screws with a 4mm hex key(J).

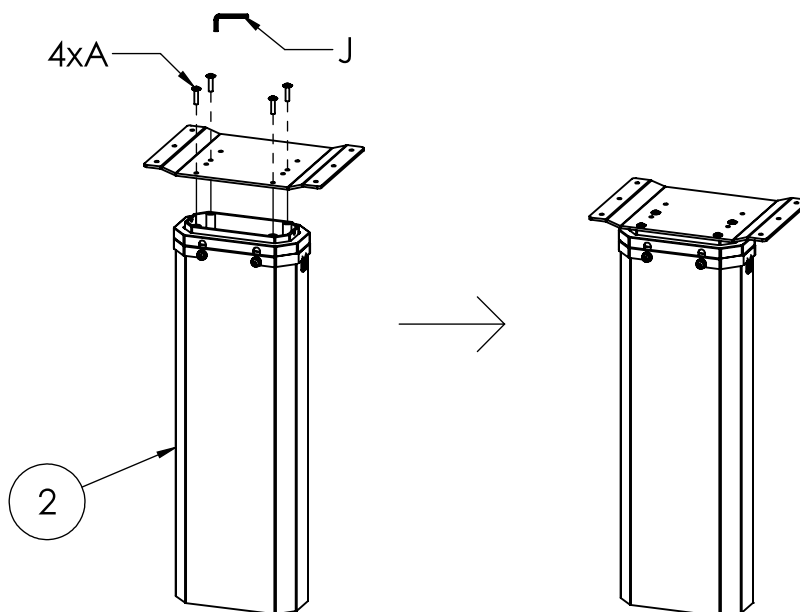

Step 3. Mount the base

Turn the columns(2) upside-down and place the four bases(5) upon them. Mount with sixteen M8x30 machine screws(B), and afterwards turn the eight M10x38 glides(C) in the threaded holes in the base. Tighten the screws with a 5mm hex key(I).

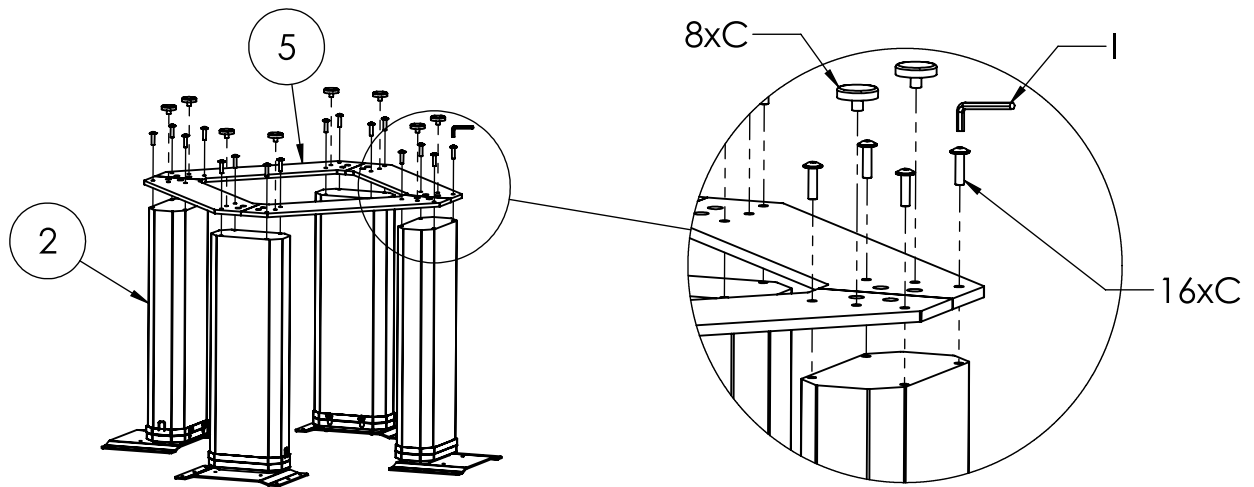

Step 4. Mount the framebars

Turn the setup to stand on the base(5). Connect the four columns(2) by mounting four framebars(6) and four framebar brackets(7) with eight M6x30 machine screws(D). Tighten screws with a 4mm hex key(J)

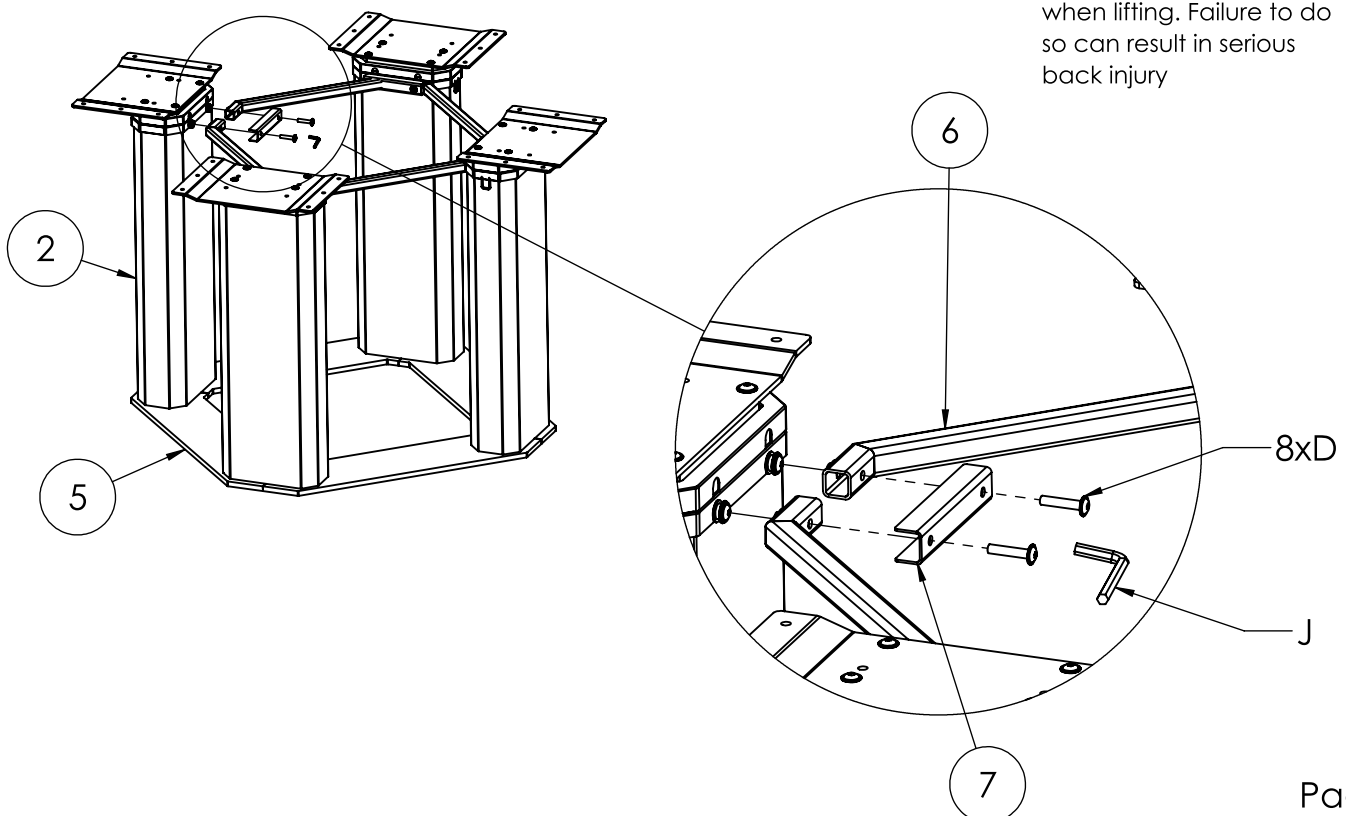

Step 5. Mount tabletop to the top bracket

Mount tabletop (8) to tabletop bracket (4). If the tabletop has counterbored holes with bushings, use six M6x16 machine screws (E), if not use six 5x20 chipboard screws (F).

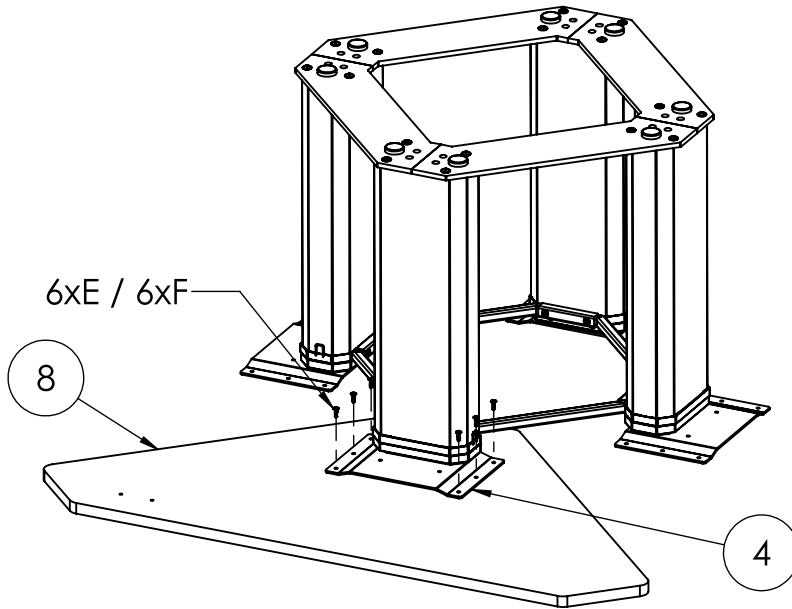

Step 6. Mount hatprofile to the tabletop

Mount hatprofile (9) parallel to the tabletop bracket (4) as shown, using six 5x20 chipboard screws (F)

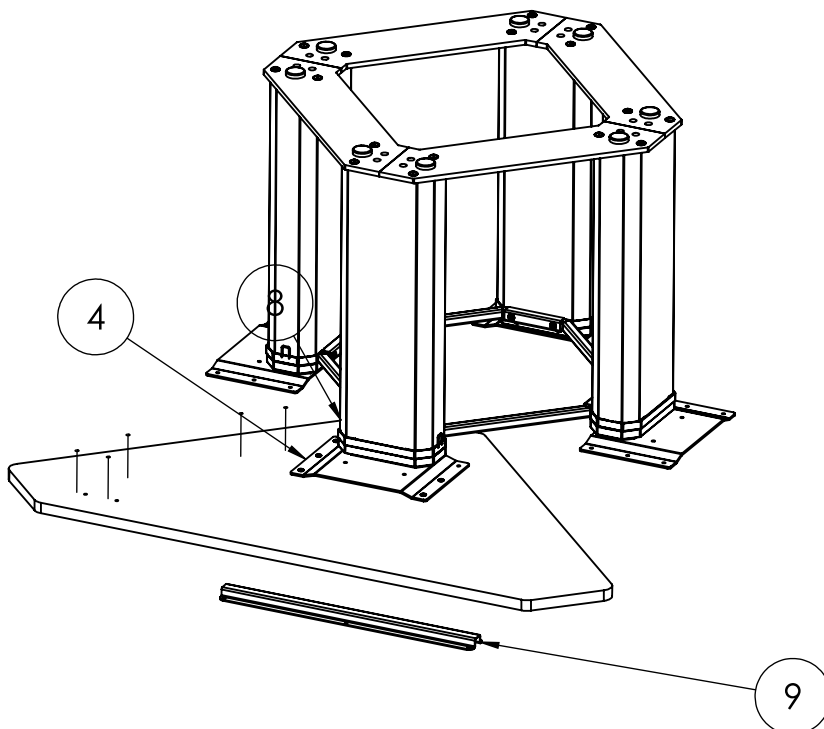

Step 7. Secure the handle and cable

Mount the handle(10) to the tabletop(8) and secure the cable in the best suited position using three cable clamps(H). Attach with five PH4x16 screws(G).

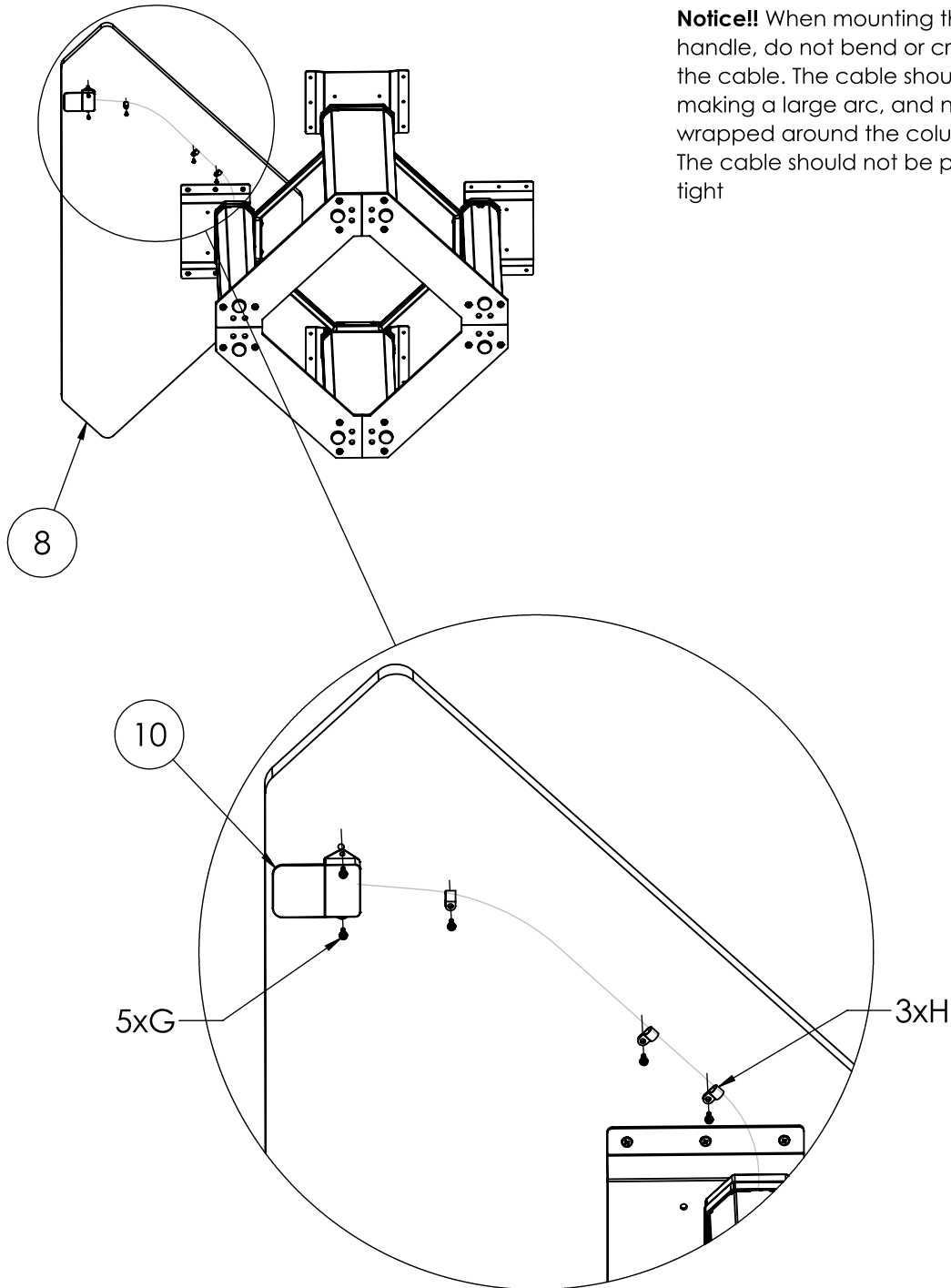

Notice!! When mounting the handle, do not bend or crimp the cable. The cable should be making a large arc, and not wrapped around the column. The cable should not be pulled tight

Step 8. Remove the safety bracket

Remove the safety bracket(3) and push the plastic-cover(1) downwards, to cover the holes in the column(2).

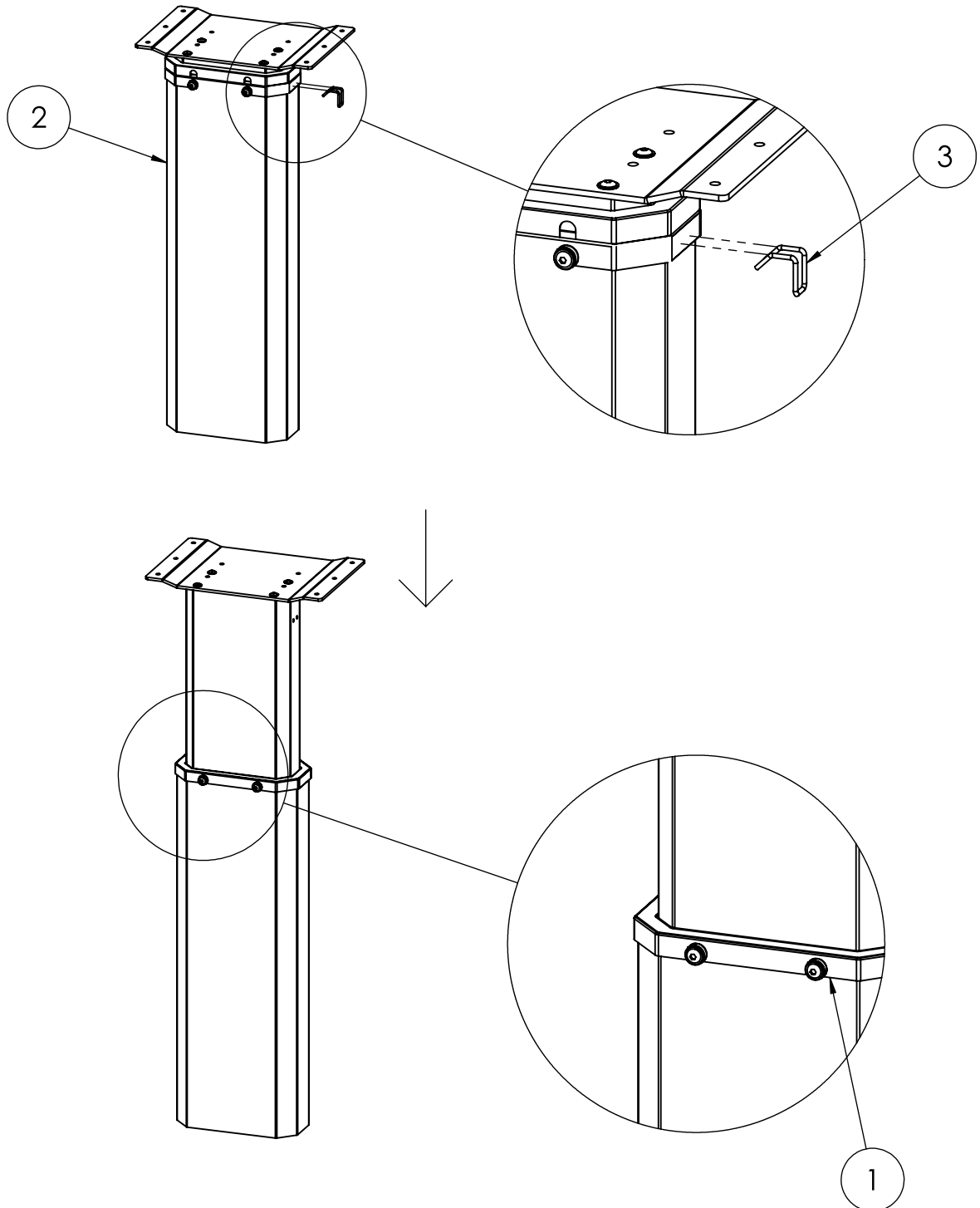

Step 9. Repeat

Repeat step 5-8 to mount the tabletop(8), hatprofiles(9) and handle(10) to the remaining three columns(2).

